

Mitchell Community Centre



Expressions of Interest are invited
for the Lease of:

Mitchell Community Centre

12 Goodrich Close
Kingston upon Hull
HU12 0BG

Situated at the heart of the
Bridlington Avenue and Fountain
Road Communities
(Central Area)



Tel No. (01482) 300300

wykearea.team@hullcc.gov.uk

Location:

The Mitchell Community Centre is within the Riverside Area, Central Ward at the heart of the community covering Bridlington Avenue and Fountain Road. The Centre is surrounded by a mix of rented and private housing and is located a short distance from the A1079, approximately 1 mile north west of the City Centre.

Accommodation:

The property is a purpose built single storey Community Centre with large hall, meeting rooms, WC'S, kitchen facilities, plant room, storage and own enclosed car park

Area	Gross Internal Area	6,610 sq ft	614 sq m
	Ancillary	30,903 sq ft	2,871 sq m

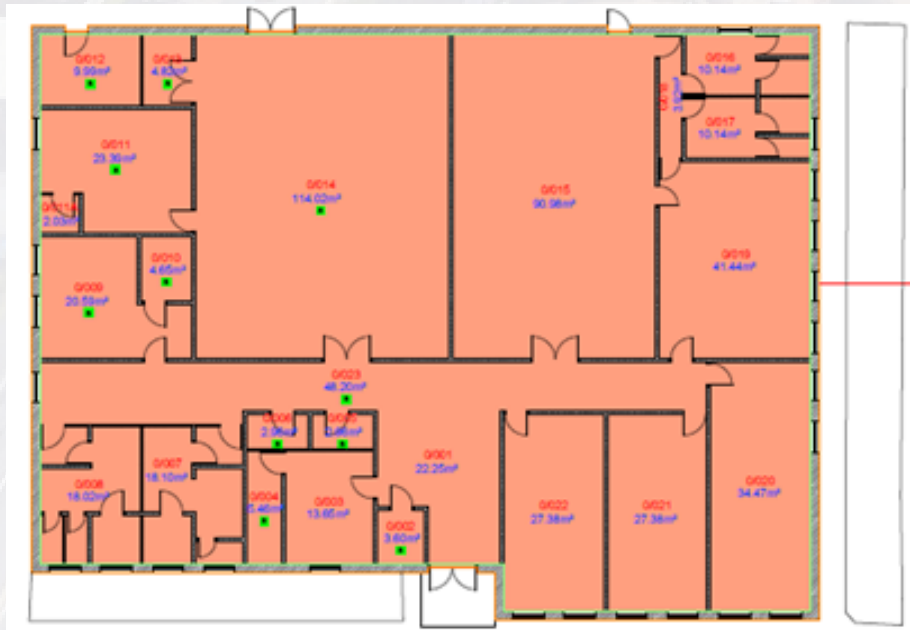

Utilities / Services:

Water, electricity and gas supplies to the property as well as a telephone line. The Centre has gas central heating to most of the accommodation. (Note: Initially , there maybe some financial assistance (up to 50%) of the costs of the utilities from Hull City Council but the tenant will be expected to become fully self funding in due course).

Planning

The property falls within Class F2 of the Use Classes Order 1987 (as amended). Any interested applicants should make their own enquiries to satisfy their planning requirements.

Business Rates

RV

£14,750

The successful applicant will be responsible for the payment of business rates.

Terms

The property will be made available as a Community Asset Transfer on internal repairing and insuring terms.

VAT

The property is not registered for VAT purposes.

EPC

G

(Note: Hull City Council is currently undertaking a strategic investment review to fund works to the Centre to to bring the current rating to an E. These works will run concurrently with this CAT Expressions of Interest process and are due to commence in March 2024).

To arrange access contact: Jenna Robinson

Email: wykearea.team@hullcc.gov.uk